



## Quick Start Guide

### HypotULTRA®

for the following models: 7800, 7820, 7850



## SAFETY CHECKLIST

- S**urvey the test station. Make sure it is safe & orderly.
- A**lways keep unqualified/unauthorized personnel away from the test area.
- F**amiliarize yourself with safety protocols in the event of a problem.
- E**xercise caution and never touch products or connections during a test.
- T**rain operators. Never touch clips directly & always connect the return lead first.
- Y**ou should always know when a test is being performed.



WARNING: THIS GUIDE WAS CREATED FOR OPERATORS HAVING SOME FAMILIARITY WITH ELECTRICAL SAFETY TESTING. AN ELECTRICAL SAFETY TESTER PRODUCES VOLTAGES AND CURRENTS THAT CAN CAUSE HARMFUL OR FATAL ELECTRIC SHOCK. TO PREVENT ACCIDENTAL INJURY OR DEATH, THESE SAFETY PROCEDURES MUST BE STRICTLY OBSERVED WHEN HANDLING AND USING A TEST INSTRUMENT. CONTACT US AT [info@arisafety.com](mailto:info@arisafety.com) FOR MORE INFO ON HOW TO GET TRAINED ON ELECTRICAL SAFETY TESTING.

# TOUCH SCREEN OPERATIONS



Back



Home



Test  
Screen

## TOUCH

Tap the virtual buttons to open various functions.

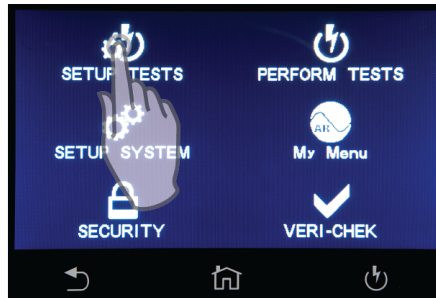

## SWIPE UP, DOWN, LEFT & RIGHT

Simple gestures allow you to quickly move through screens & parameters.

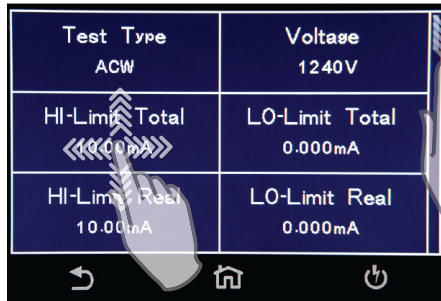

## DRAG & DROP

Simply touch and hold the test file, test step, or parameter and drag the file to the appropriate location.



# INSTRUMENT SET UP



**WARNING:** LOCATE A SUITABLE TESTING AREA WITH A CLASS I GROUNDED OUTLET. BE SURE THAT THE CLASS I GROUNDED OUTLET HAS BEEN TESTED FOR PROPER WIRING. MAKE SURE YOU READ THE SAFETY CHECKLIST OF THIS GUIDE BEFORE USING THE INSTRUMENT.

- 1 Connect the female end of the standard NEMA style line power (mains) cord into the input power receptacle on the rear panel of the instrument and plug the male end of the cord into a grounded power source.
- 2 Connect the Interlock Disable Key to the Signal Input connector on the back panel of the instrument if you're not utilizing a DUT enclosure (P/N 39064 or 39656) or other safety device. This is required in order to run a test.
- 3 Turn the instrument power switch ON.

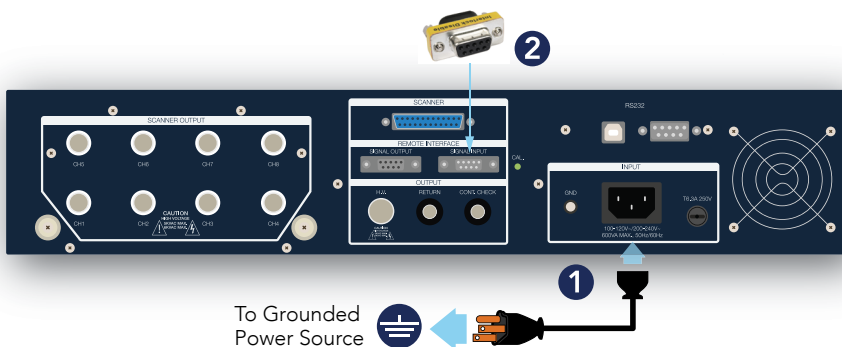

# TEST SET UP

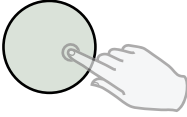

**PRESS POWER**

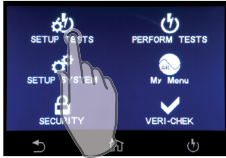

**TAP SETUP TESTS**

Home Screen

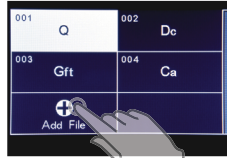

**TAP ADD FILE**

File Screen



**ADD FILE NAME**

Tap the ENTER (  ) key to save your selection

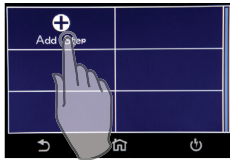
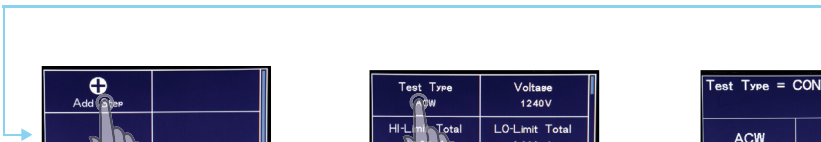

**TAP ADD STEP**

Add Step



**TAP TEST TYPE**

Test Parameter Screen

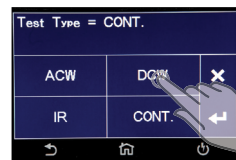

**SELECT TEST TYPE**

Tap the ENTER (  ) key to save your selection

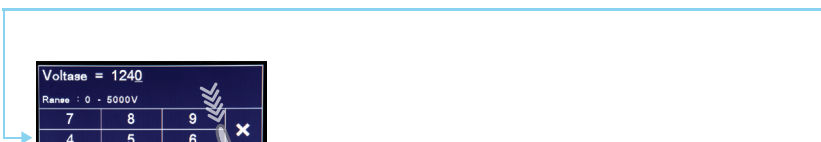

**VIEW PARAMETERS**

Swipe left or right to scroll through parameters and tap parameter values to edit. After you adjust the parameters, tap the ENTER (  ) arrow key to save changes.

# ADAPTOR BOX CONNECTIONS



DO NOT TOUCH THE DEVICE UNDER TEST ONCE YOU START THE TEST.

The adapter box provides an easy way to connect the HypotULTRA to a device under test (DUT) terminated in a two- or three-prong power cord. The following diagram shows how to connect the adapter box to the HypotULTRA and to the DUT.

**Note:** If you need to perform a Ground Continuity test, be sure you enable the Ground Continuity test type before moving forward.

- 1 Plug the black cord from the adapter box (P/N 36544) into the continuity output terminal located on the front panel.
- 2 Plug the white cord from the adapter box (P/N 36544) into the high voltage output terminal located on the front panel.
- 3 Connect the black ground return lead (P/N 2100A-13) to the front panel return output terminal and connect the other end of the lead to the dead metal on the chassis of the DUT. Always check to be sure a good connection has been made between the DUT and the return clip.
- 4 Plug the line cord of the DUT into the adapter box receptacle.

**Note:** You may also use the rear output terminals on the back of the HypotULTRA instead of the front panel output terminals.

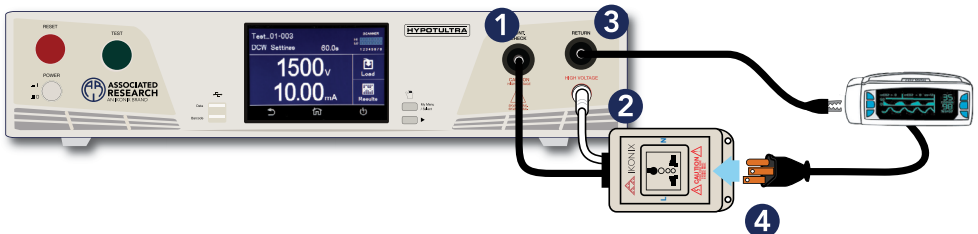

# TEST LEAD CONNECTIONS



DO NOT TOUCH THE DEVICE UNDER TEST ONCE YOU START THE TEST.

If there is no ground circuit on your DUT, you may use the test leads to connect the HypotULTRA to your DUT. Turn off the Continuity function for this connection.

- 1 Plug the black ground return lead (P/N 2100A-13) into the Return terminal on the front panel of the instrument.
- 2 Connect the high voltage lead (P/N 4040A-08) into the High Voltage terminal on the front panel of the instrument.
- 3 Connect the black ground return lead (P/N 2100A-13) to the dead metal on the chassis of the DUT. Always check to be sure a good connection has been made between the DUT and the return clip.
- 4 Attach the high voltage lead (P/N 4040A-08) to the current carrying conductors of the DUT.

After you make the proper connections, you can initiate a test from the front panel of the HypotULTRA by pressing the green TEST button. Press the red RESET button to abort a test in process.



# PERFORM TESTS

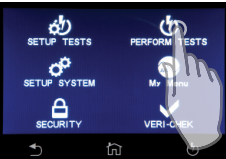

**TAP PERFORM TESTS**

OR

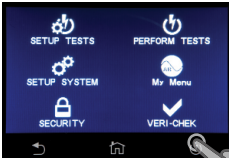

**TAP TEST SCREEN  
BUTTON AT THE  
BOTTOM OF THE  
TOUCH SCREEN**



**PUSH THE  
TEST BUTTON**

# RESULTS

After a test has completed, the Results icon will be available on the screen. Tap RESULTS to view your test results.

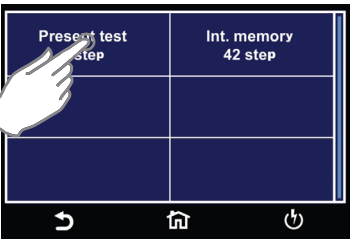

Tap “Present test step” to view the results of the last test step.

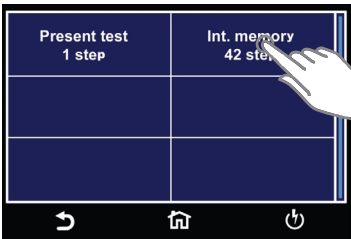

Tap “Int. memory” to view the previously performed steps.



SCAN FOR  
VIDEO  
LIBRARY



Experts In Electrical Safety Compliance.®



**ASSOCIATED  
RESEARCH**  
AN IKONIX BRAND

**Cal Power**

Via Acquanera, 29  
tel. 031.526.566 (r.a.)  
[info@calpower.it](mailto:info@calpower.it)

22100 COMO  
fax 031.507.984  
[www.caltower.it](http://www.caltower.it)

For additional information about these and other key features of the HypotULTRA, please consult the full Operation and Service Manual or call us toll-free 1-800-TEST (8378) or +1-847-367-4077.

©2022 Associated Research [www.arisafety.com](http://www.arisafety.com)

12/2022